

冷轧滚珠丝杠+2相步进电机 / Rolled Ball Screw + 2-Phase Stepping Motor

2TMB □42 / NEMA 17

Shaft dia. (轴径) f8

【2TMB0801 / 2TMB0802 / 2TMB0805】

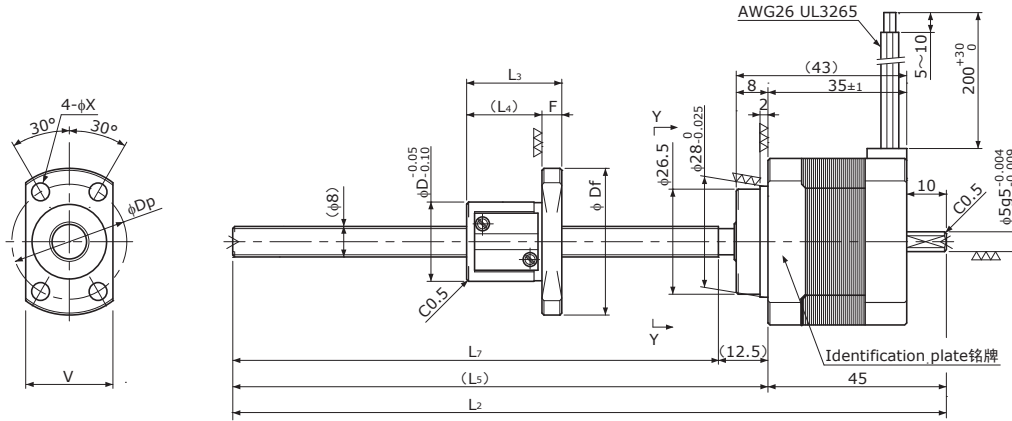

Motor Wire / 电机线	
A	Red(红)
A	Blue(蓝)
B	Yellow(黄)
B	White(白)

【2TMB0812】

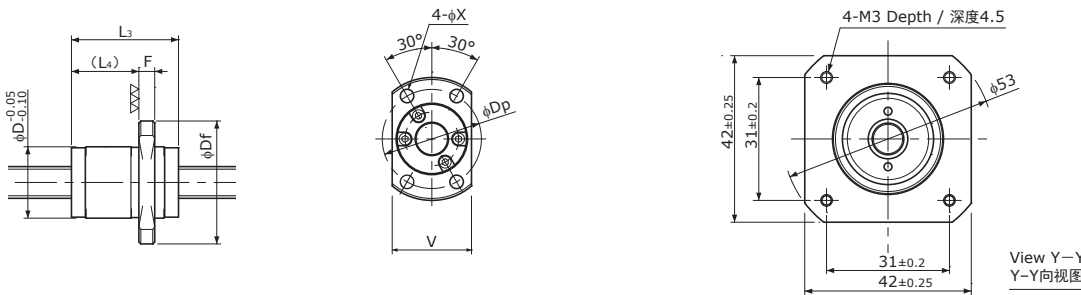

Unit(单位):mm

Model 型号	Lead 导程	Travel 行程	Reference Thrust 参考推力 (N)	L ₂	L ₃	L ₇	D	D _f	F	L ₃	L ₄	V	D _p	X	Mass 质量 (g)
2TMB0801	1	150	75	240	195	182.5	16	29	4	17	13	18	23	3.4	350
2TMB0802	2	150	100	250	205	192.5	20	37	5	24	19	22	29	4.5	400
2TMB0805	5	150	50	250	205	192.5	18	31	4	28	24	20	25	3.4	400
2TMB0812	12	150	25	250	205	192.5	18	31	4	27	17	20	25	3.4	400

Recommended Drivers 推荐驱动器	SD4030B3
------------------------------	----------

Note) Refer to page P162 for connection diagram of recommended Drivers.
注) 有关与推荐驱动器的接线, 请参照P162页。

Ball Screw Specifications 滚珠丝杠主要技术参数	
Accuracy grade 精度等级	Equivalent to JIS Ct7 相当于Ct7
Thread direction 旋向	Right 右
Axial play 轴向间隙	0.03mm or less 0.03mm以下
Shaft material 丝杠轴材质	Stainless steel 不锈钢
Nut material 螺母材质	Chrome-molybdenum steel 铬钼钢
Surface hardness 螺纹部表面硬度	Min. HRC55 (Thread area)
Lubricant 润滑剂	KSS original grease MSG No.2 KSS原装油脂 MSG No.2

Note) Please refer to page P119 for about end-journal turning.
注) 关于追加加工, 请参照P119页。

Motor Specifications 电机参数	
Basic step angle 基本步进角	1.8°
Driving method 励磁方式	2-phase Bi-polar 2相双极方式
Rated Voltage 额定电压	DC 2.2 V
Rated current 额定电流	DC 2.0 A/phase DC 2.0 A/相
Winding resistance 绕组电阻	1.1 Ω
Holding Torque 保持扭矩	0.24 Nm
Rotor inertia 转子惯量	42 g · cm ²
Operating temperature 使用温度范围	-20°C~50°C