

# SG0402

Shaft dia.  $\phi 4$  Lead 2mm

# C3

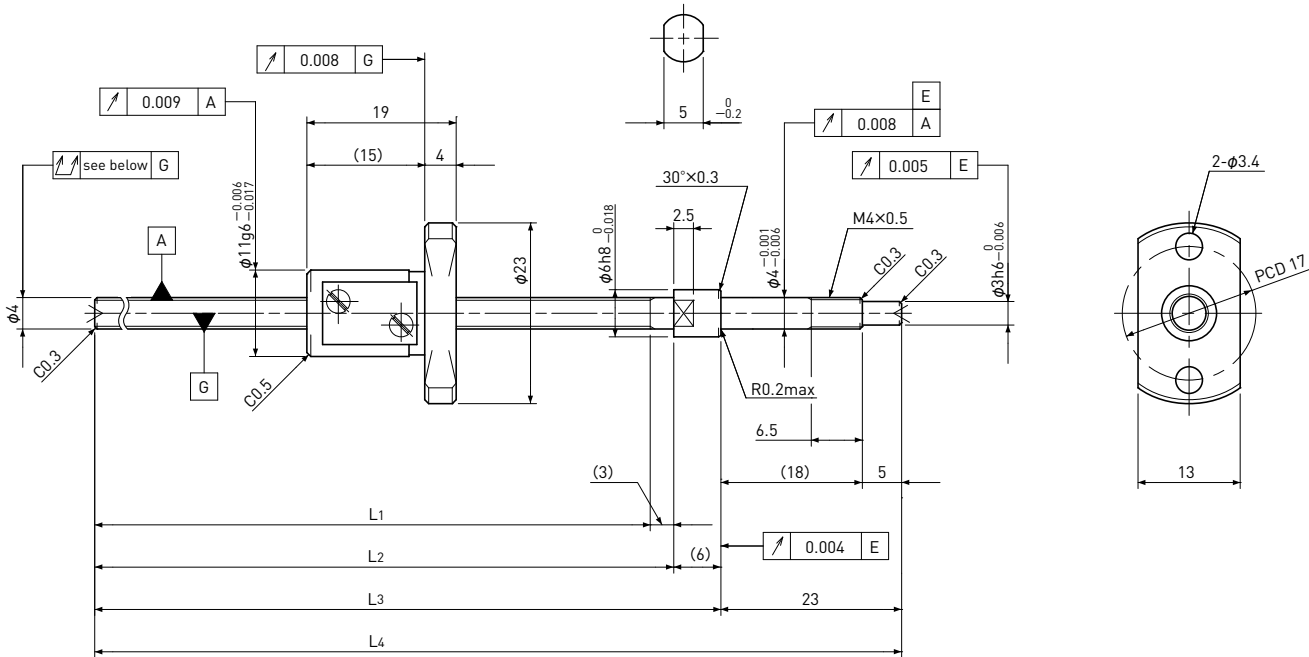

Unit: mm

Ball Screw Specifications	
Ball size	$\phi 0.8$
Number of thread	1
Thread direction	Right
Shaft root dia.	$\phi 3.3$
Number of circuit	$2.7 \times 1$
Shaft, Nut material	SCM415H
Surface hardness	HRC58~62 (Thread area)
Anti-rust treatment	Anti-rust oil

### Supported-side end-journal profile

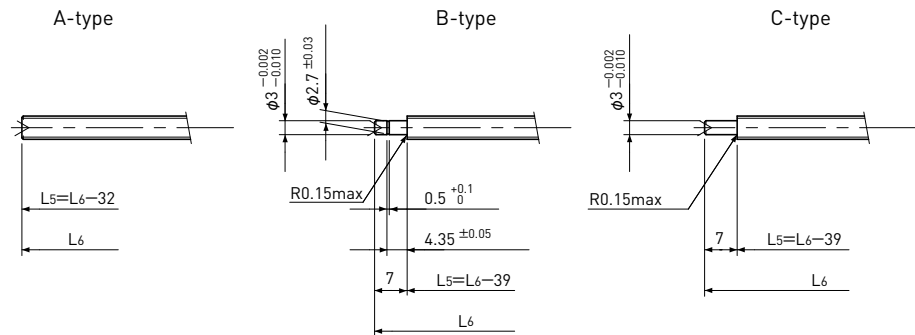

L5: Thread length after end-journal machining.  
L6: Total length after end-journal machining.

Support-unit Recommendation	Supported-side	Fixed-side
	MSU-4CS/4GS	MSU-4C/4G

D-type : Other than the above.

Unit: mm

Ball Screw Model	Travel	Grade	Shaft length				Lead accuracy		Total Run-out	Axial play	Preload Torque Nm	Basic Load Rating N	
			L <sub>1</sub>	L <sub>2</sub>	L <sub>3</sub>	L <sub>4</sub>	Travel deviation e <sub>p</sub>	Variation V <sub>u</sub>				Dynamic Ca	Static Coa
SG0402-103R135C3	80	C3	103	106	112	135	$\pm 0.010$	0.008	0.035	~0.005	—	420	570

Note) Please refer to page A206 for order code of end-journal machining.