

SR1520

Shaft dia. $\phi 15$ Lead 20mm

Ct7&Ct10

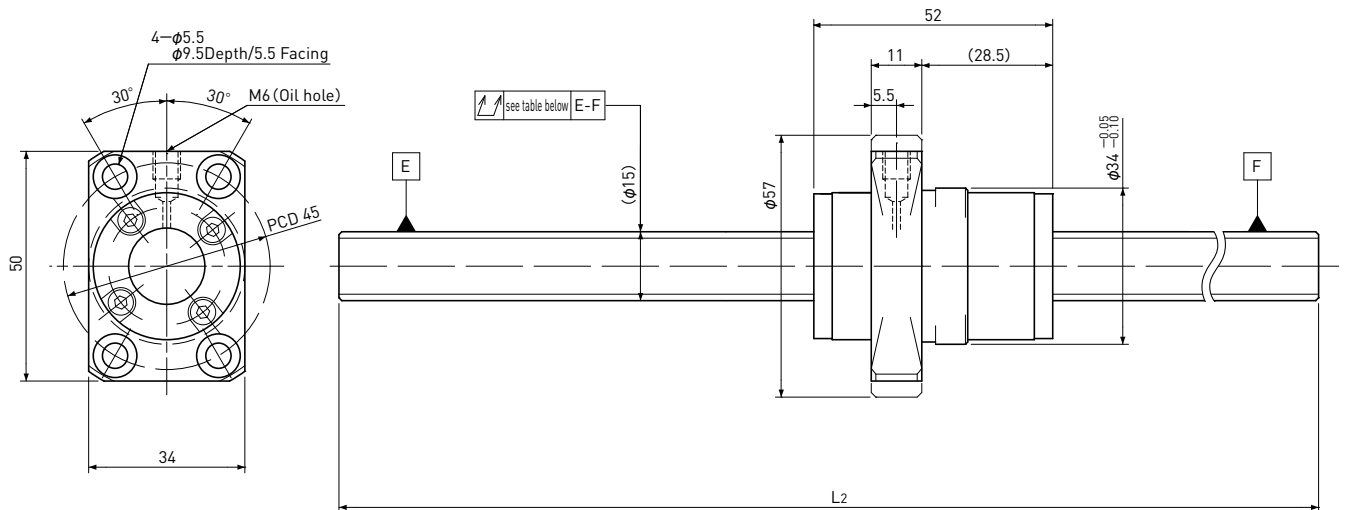

Unit: mm

Ball Screw Specifications		
Ball size	$\phi 3.175$	
Number of thread	2	
Thread direction	Right	
Shaft root dia.	$\phi 12.7$	
Number of circuit	1.7 \times 2	
Material	Shaft	SUJ2
	Nut	SCM415
Surface hardness	HRC58~62 (Thread area)	
Anti-rust treatment	Anti-rust oil	

Unit: mm

Ball Screw Model	Travel	Grade	Shaft length		Lead accuracy		Total Run-out \nearrow	Axial play	Preload Torque Nm	Basic Load Rating N	
			L ₁	L ₂	Travel deviation e_p	Variation V ₃₀₀				Dynamic C _a	Static C _{0a}
SR1520-1000R1000C7	945	Ct7	—	1000	± 0.17	0.05	0.200	~ 0.020	—	8000	16000
SR1520-1000R1000C10	945	Ct10	—	1000	± 0.7	0.21	0.400	~ 0.050			

Note) Please designate end-journal profile with your sketch.