

# SRT0401K | Compact Nut

Shaft dia.  $\phi 4$  Lead 1mm

| Ct7 & Ct10 |

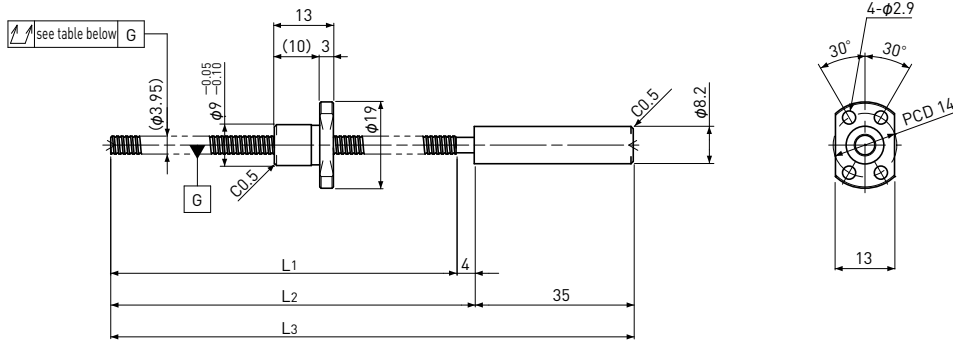

Unit: mm

Ball Screw Specifications		
Ball size		$\phi 0.6$
Number of thread		1
Thread direction		Right
Shaft root dia.		$\phi 3.4$
Number of circuit		1 × 3
Material	Shaft	S55C+SUS303
	Nut	SCM415H
Surface hardness		HRC58~ (Thread area)
Anti-rust treatment		Anti-rust oil

End-journal profile Supported-side			Fixed-side
A-type	B-type	C-type	
<p>L4: Thread length after end-journal machining. L5: Total length after end-journal machining.</p>			
Support-unit Recommendation			Supported-side : MSU-4CS/4GS, SUP03-S
			Fixed-side : MSU-4C/4G, EK4

D-type : Other than the above.

Unit: mm

Ball Screw Model	Travel	Grade	Shaft length			Lead accuracy		Total Run-out	Axial play	Preload Torque Nm	Basic Load Rating N	
			L1	L2	L3	Travel deviation $e_p$	Variation $V_{300}$				Dynamic $C_a$	Static $C_{oa}$
SRT0401K-76R115C7	60	Ct7	76	80	115	$\pm 0.02$	—	0.080	$\sim 0.020$	—	300	430
SRT0401K-76R115C10	60	Ct10	76	80	115	$\pm 0.05$	—	0.160	$\sim 0.050$			

Note ) Please refer to p-A287 for order code of end-journal machining.