

SRT0504

Shaft dia. $\phi 5$ Lead 4mm

Ct7&Ct10

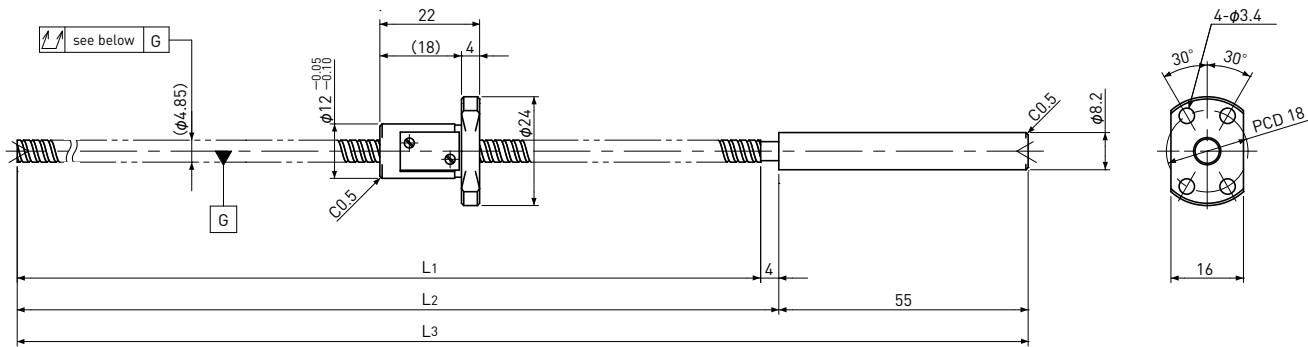

Unit : mm

Ball Screw Specifications		
Ball size		$\phi 0.8$
Number of thread		1
Thread direction		Right
Shaft root dia.		$\phi 4.3$
Number of circuit		2.7×1
Material	Shaft	SCM415H+SUS303
	Nut	SCM415H
Surface hardness		HRC58~ (Thread area)
Anti-rust treatment		Anti-rust oil

End-journal profile Supported-side

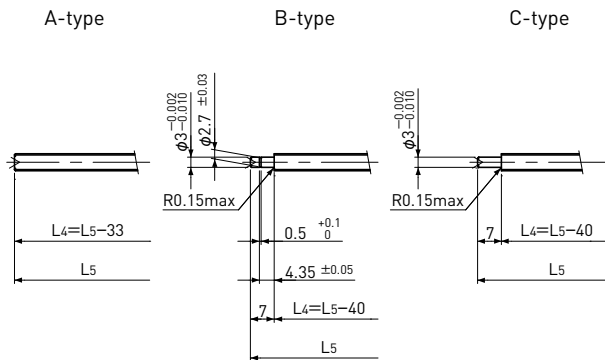

L4: Thread length after end-journal machining.
L5: Total length after end-journal machining.

Fixed-side

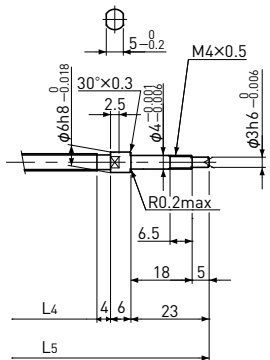

Support-unit Recommendation	Supported-side	MSU-4CS/4GS
	Fixed-side	MSU-4C/4G

D-type : Other than the above.

Unit : mm

Ball Screw Model	Travel	Grade	Shaft length			Lead accuracy		Total Run-out	Axial play	Preload Torque Nm	Basic Load Rating N	
			L1	L2	L3	Travel deviation e_p	Variation V_{300}				Dynamic C_a	Static C_{oa}
SRT0504-96R155C7	70	Ct7	96	100	155	± 0.02	—	0.080	~0.020	—	470	720
SRT0504-216R275C7	190	Ct7	216	220	275	± 0.03	—	0.120				
SRT0504-96R155C10	70	Ct10	96	100	155	± 0.06	—	0.160	~0.050	—	470	720
SRT0504-216R275C10	190	Ct10	216	220	275	± 0.15	—	0.240				

Note) Please refer to page A287 for order code of end-journal machining.