

SRT0601K

Compact Nut
Shaft dia. $\phi 6$ Lead 1mm

Ct7&Ct10

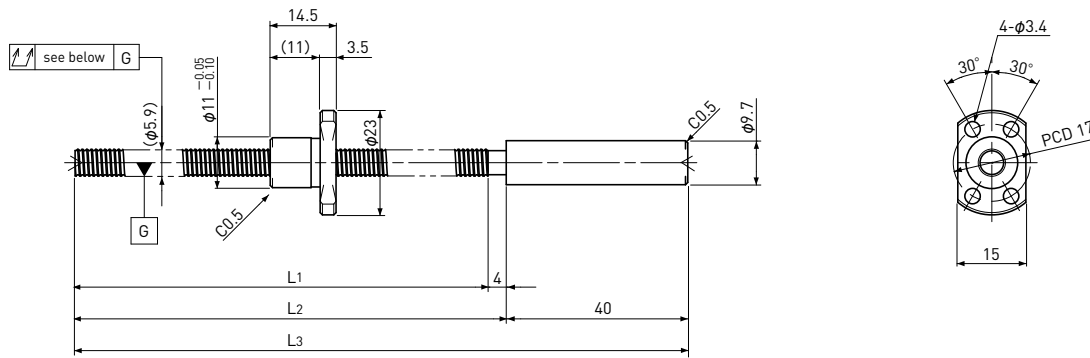

Unit : mm

Ball Screw Specifications		
Ball size		$\phi 0.8$
Number of thread		1
Thread direction		Right
Shaft root dia.		$\phi 5.3$
Number of circuit		1×3
Material	Shaft	S55C+SUS303
	Nut	SCM415H
Surface hardness		HRC58~ (Thread area)
Anti-rust treatment		Anti-rust oil

End-journal profile Supported-side

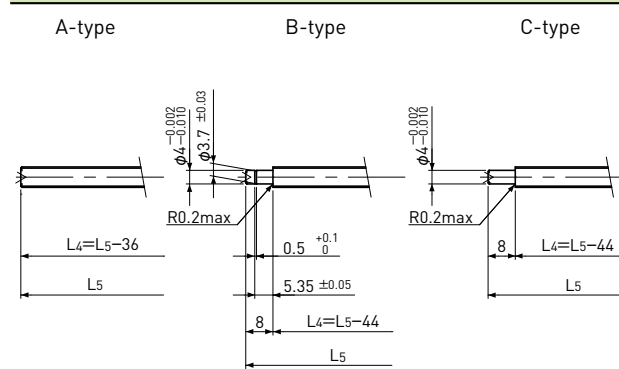

L4: Thread length after end-journal machining.
L5: Total length after end-journal machining.

Fixed-side

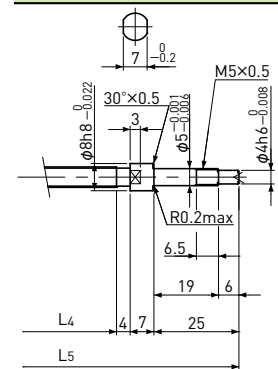

Support-unit Recommendation	Supported-side	Fixed-side
	MSU-5CS/5GS	MSU-5C/5G

D-type : Other than the above.

Unit : mm

Ball Screw Model	Travel	Grade	Shaft length			Lead accuracy		Total Run-out	Axial play	Preload Torque Nm	Basic Load Rating N	
			L ₁	L ₂	L ₃	Travel deviation e _p	Variation V ₃₀₀				Dynamic Ca	Static Coa
SRT0601K-91R135C7	70	Ct7	91	95	135	±0.02	—	0.080	~0.020	—	560	950
SRT0601K-91R135C10	70	Ct10	91	95	135	±0.06	—	0.160	~0.050			

Note) Please refer to page A287 for order code of end-journal machining.