

# SRT0606

Shaft dia.  $\phi 6$  Lead 6mm

Ct7&Ct10

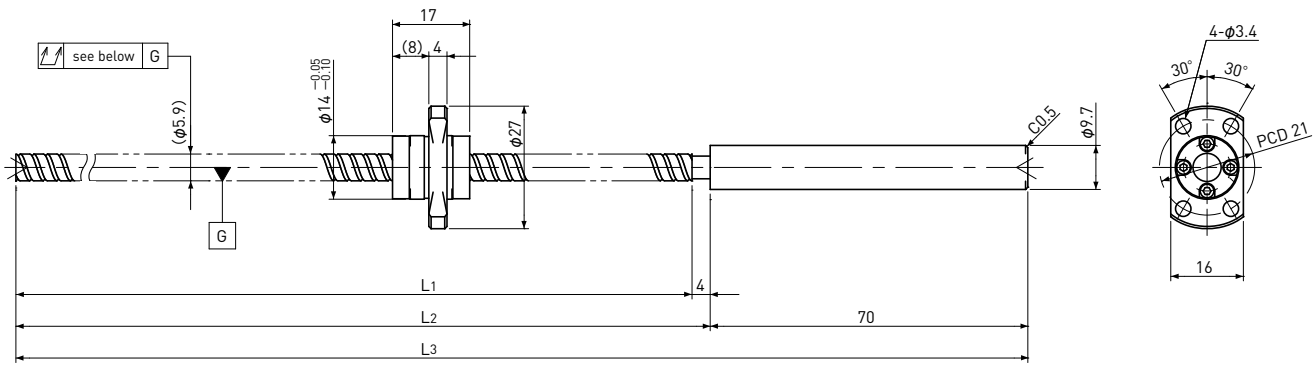

Unit : mm

Ball Screw Specifications		
Ball size		$\phi 1.0$
Number of thread		2
Thread direction		Right
Shaft root dia.		$\phi 5.2$
Number of circuit		1.6 × 2
Material	Shaft	SCM415H+SUS303
	Nut	SCM415H
Surface hardness		HRC58~ (Thread area)
Anti-rust treatment		Anti-rust oil

### End-journal profile Supported-side

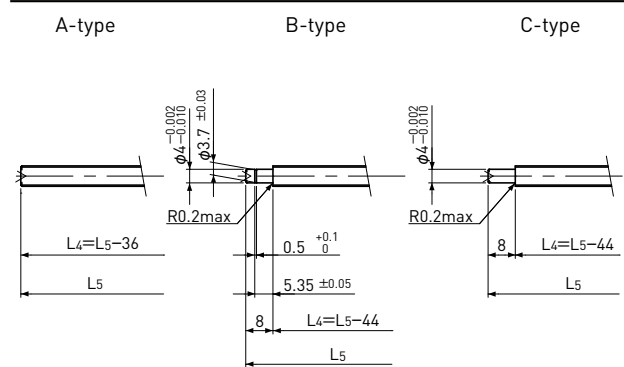

L4: Thread length after end-journal machining.  
L5: Total length after end-journal machining.

### Fixed-side

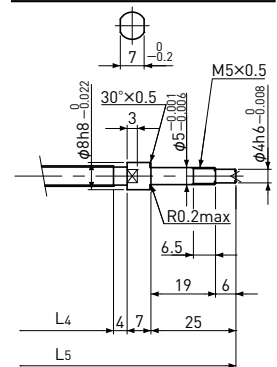

Support-unit Recommendation	Supported-side	MSU-5CS/5GS
	Fixed-side	MSU-5C/5G

D-type : Other than the above.

Unit : mm

Ball Screw Model	Travel	Grade	Shaft length			Lead accuracy		Total Run-out	Axial play	Preload Torque Nm	Basic Load Rating N	
			L1	L2	L3	Travel deviation $e_p$	Variation $V_{300}$				Dynamic $C_a$	Static $C_{oa}$
SRT0606-146R220C7	125	Ct7	146	150	220	$\pm 0.02$	—	0.080	~0.020	—	870	1450
SRT0606-261R335C7	240	Ct7	261	265	335	$\pm 0.04$	—	0.120				
SRT0606-146R220C10	125	Ct10	146	150	220	$\pm 0.10$	—	0.160	~0.050	—	870	1450
SRT0606-261R335C10	240	Ct10	261	265	335	$\pm 0.18$	—	0.240				

Note ) Please refer to page A287 for order code of end-journal machining.