

SRT1002K

Compact Nut
Shaft dia. $\phi 10$ Lead 2mm

Ct7&Ct10

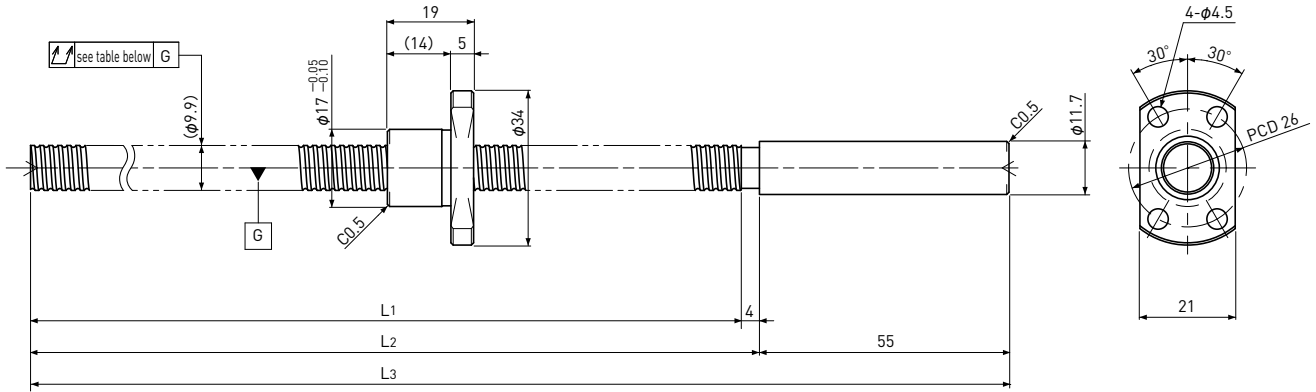

Unit: mm

Ball Screw Specifications	
Ball size	$\phi 1.2$
Number of thread	1
Thread direction	Right
Shaft root dia.	$\phi 9.0$
Number of circuit	1×3
Material	Shaft: S55C+SUS303
	Nut: SCM415H
Surface hardness	HRC58~ (Thread area)
Anti-rust treatment	Anti-rust oil

End-journal profile Supported-side

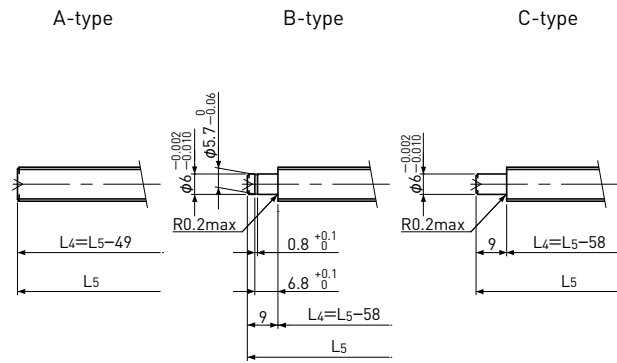

L4: Thread length after end-journal machining.
L5: Total length after end-journal machining.

Fixed-side

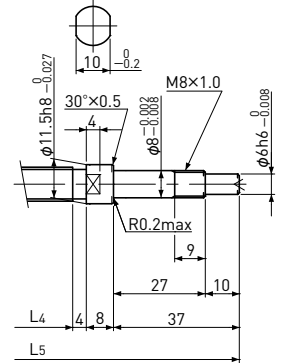

Support-unit Recommendation	Supported-side	MSU-8CS/8GS, EF8
	Fixed-side	MSU-8C/8G, EK8

D-type : Other than the above.

Unit: mm

Ball Screw Model	Travel	Grade	Shaft length			Lead accuracy		Total Run-out	Axial play	Preload Torque Nm	Basic Load Rating N	
			L1	L2	L3	Travel deviation e_p	Variation V_{300}				Dynamic C_a	Static C_{0a}
SRT1002K-201R260C7	175	Ct7	201	205	260	± 0.03	—	0.080	~ 0.020	—	1450	3000
SRT1002K-201R260C10	175	Ct10	201	205	260	± 0.14	—	0.160	~ 0.050			

Note) Please refer to p-A287 for order code of end-journal machining.