

SRT1005

Shaft dia. ϕ 10 Lead 5mm

| Ct7&Ct10 |

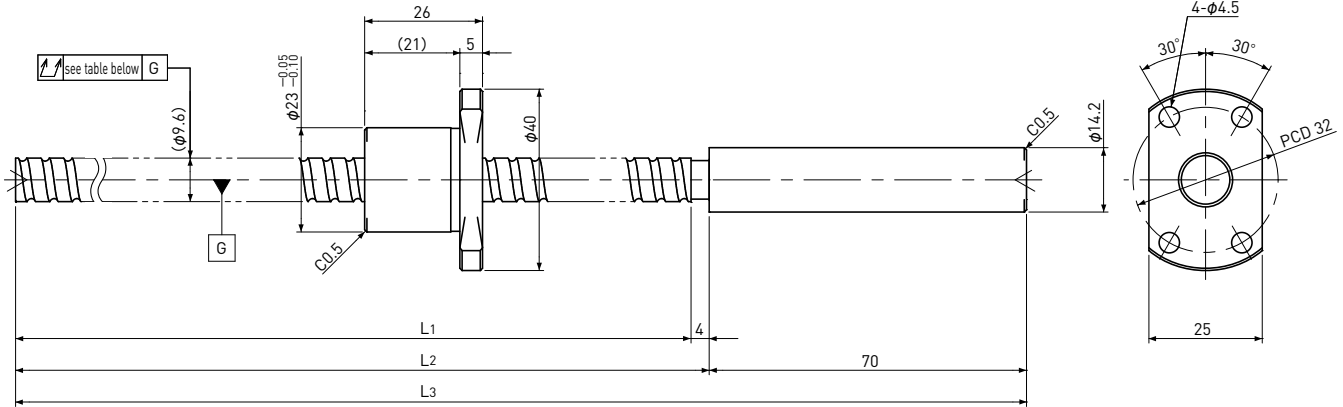

Unit: mm

Ball Screw Specifications	
Ball size	ϕ 2.0
Number of thread	1
Thread direction	Right
Shaft root dia.	ϕ 8.2
Number of circuit	2.7 × 1
Material	Shaft
	Nut
Surface hardness	HRC58~ (Thread area)
Anti-rust treatment	Anti-rust oil

End-journal profile Supported-side

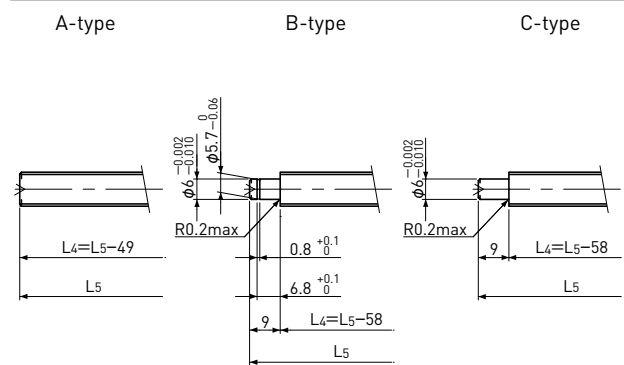

Fixed-side

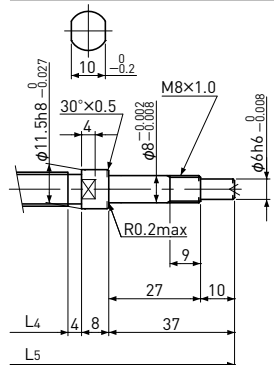

L4: Thread length after end-journal machining.
L5: Total length after end-journal machining.

Support-unit Recommendation	Supported-side	MSU-8CS/8GS, EF8
	Fixed-side	MSU-8C/8G, EK8

D-type : Other than the above.

Unit: mm

Ball Screw Model	Travel	Grade	Shaft length			Lead accuracy		Total Run-out	Axial play	Preload Torque Nm	Basic Load Rating N	
			L1	L2	L3	Travel deviation e_p	Variation V_{300}				Dynamic Ca	Static Coa
SRT1005-196R270C7	170	Ct7	196	200	270	± 0.03	—	0.080	~0.020	—	3000	5200
SRT1005-396R470C7	370	Ct7	396	400	470	± 0.06	0.05	0.120				
SRT1005-196R270C10	170	Ct10	196	200	270	± 0.13	—	0.160	~0.050	—	3000	5200
SRT1005-396R470C10	370	Ct10	396	400	470	± 0.27	0.21	0.240				

Note)Please refer to p-A287 for order code of end-journal machining.