

SRT1010

Shaft dia. $\phi 10$ Lead 10mm

Ct7&Ct10

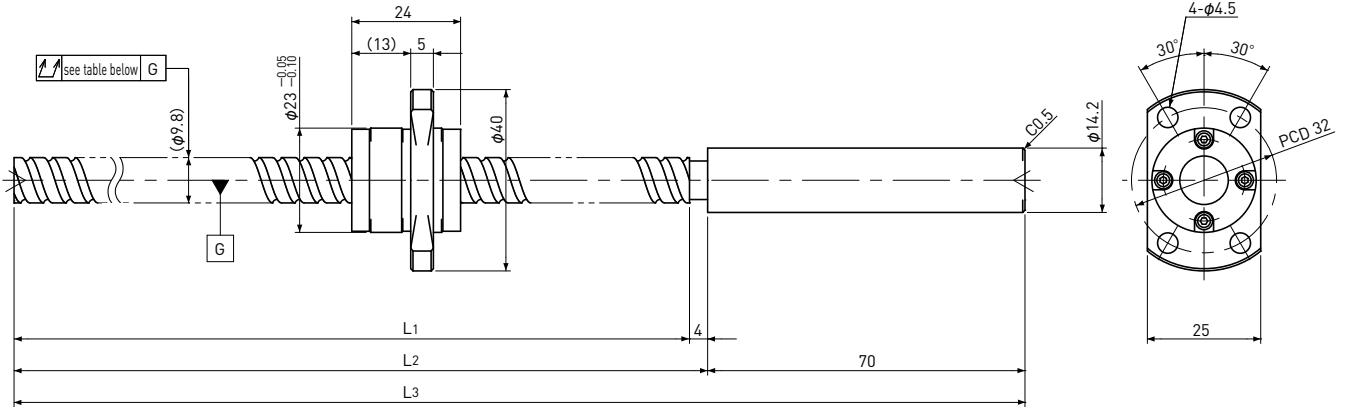

Unit: mm

Ball Screw Specifications	
Ball size	$\phi 2.0$
Number of thread	2
Thread direction	Right
Shaft root dia.	$\phi 8.4$
Number of circuit	1.6 × 2
Material	Shaft
	Nut
Surface hardness	HRC58~ (Thread area)
Anti-rust treatment	Anti-rust oil

End-journal profile Supported-side

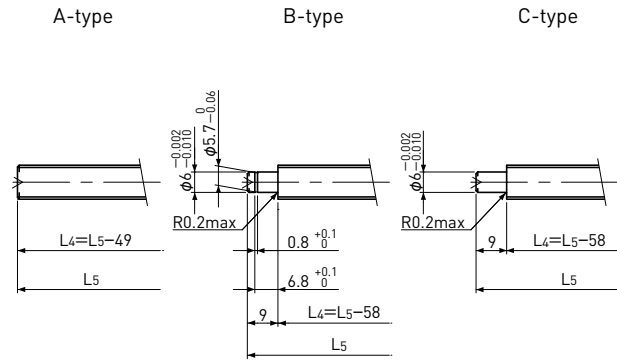

L4: Thread length after end-journal machining.
L5: Total length after end-journal machining.

Fixed-side

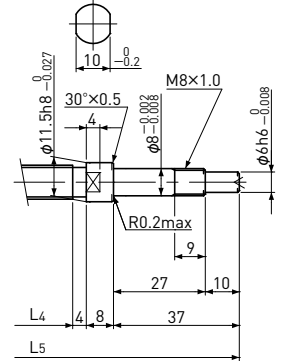

Support-unit Recommendation	Supported-side	MSU-8CS/8GS, EF8
	Fixed-side	MSU-8C/8G, EK8

D-type : Other than the above.

Unit: mm

Ball Screw Model	Travel	Grade	Shaft length			Lead accuracy		Total Run-out	Axial play	Preload Torque Nm	Basic Load Rating N	
			L1	L2	L3	Travel deviation e_p	Variation V_{300}				Dynamic C_a	Static C_{oa}
SRT1010-196R270C7	170	Ct7	196	200	270	± 0.03	—	0.080	~0.020	—	3300	5900
SRT1010-396R470C7	370	Ct7	396	400	470	± 0.06	0.05	0.120				
SRT1010-196R270C10	170	Ct10	196	200	270	± 0.13	—	0.160	~0.050			
SRT1010-396R470C10	370	Ct10	396	400	470	± 0.27	0.21	0.240				

Note) Please refer to p-A287 for order code of end-journal machining.