

SRT1210

Shaft dia. $\phi 12$ Lead 10mm

Ct7&Ct10

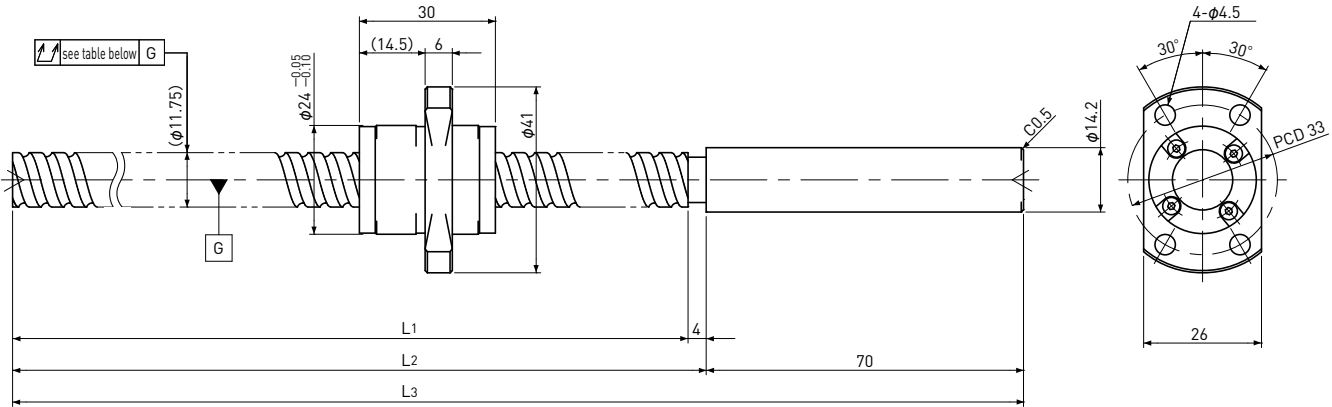

Unit: mm

Ball Screw Specifications		
Ball size		$\phi 2.381$
Number of thread		2
Thread direction		Right
Shaft root dia.		$\phi 10.2$
Number of circuit		1.7×2
Material	Shaft	SCM415H+SUS303
	Nut	SCM415H
Surface hardness		HRC58~ (Thread area)
Anti-rust treatment		Anti-rust oil

End-journal profile Supported-side

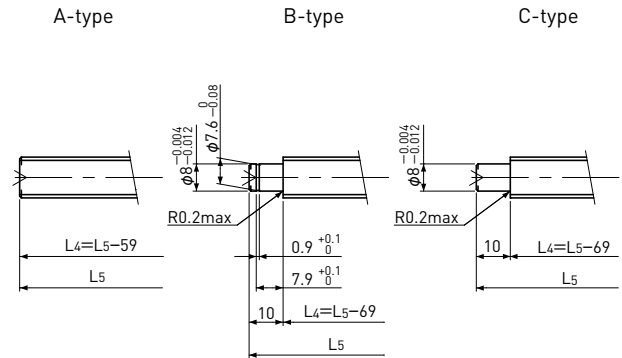

L₄: Thread length after end-journal machining.
L₅: Total length after end-journal machining.

Fixed-side

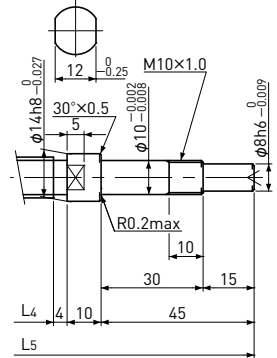

Support-unit Recommendation	Supported-side	: EF10
	Fixed-side	: EK10

D-type : Other than the above.

Unit: mm

Ball Screw Model	Travel	Grade	Shaft length			Lead accuracy		Total Run-out	Axial play	Preload Torque Nm	Basic Load Rating N	
			L ₁	L ₂	L ₃	Travel deviation e _p	Variation V ₃₀₀				Dynamic Ca	Static Coa
SRT1210-196R270C7	165	Ct7	196	200	270	±0.03	—	0.080	~0.020	—	5100	9800
SRT1210-396R470C7	365	Ct7	396	400	470	±0.06	0.05	0.080				
SRT1210-196R270C10	165	Ct10	196	200	270	±0.13	—	0.160	~0.050	—	5100	9800
SRT1210-396R470C10	365	Ct10	396	400	470	±0.27	0.21	0.160				

Note)Please refer to p-A287 for order code of end-journal machining.