

SSRT1002 | Stainless

Shaft dia. $\phi 10$ Lead 2mm

Ct7&Ct10

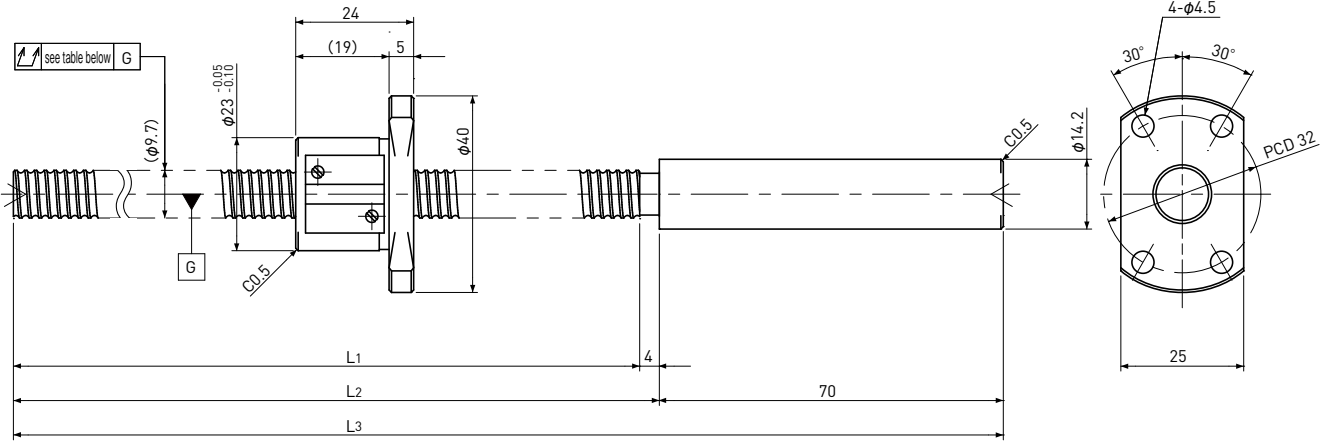

Unit: mm

Ball Screw Specifications		
Ball size		$\phi 1.5875$
Number of thread		1
Thread direction		Right
Shaft root dia.		$\phi 8.6$
Number of circuit		3.7×1
Material	Shaft	SUS440C+SUS303
	Nut	SUS440C
Surface hardness		HRC55~ (Thread area)
Anti-rust treatment		Anti-rust oil

End-journal profile Supported-side			Fixed-side
A-type	B-type	C-type	
<p>L4: Thread length after end-journal machining. L5: Total length after end-journal machining.</p>			
Support-unit Recommendation		Supported-side	MSU-8CS/8GS, EF8
		Fixed-side	MSU-8C/8G, EK8
D-type : Other than the above.			

Unit: mm

Ball Screw Model	Travel	Grade	Shaft length			Lead accuracy		Total Run-out	Axial play	Preload Torque Nm	Basic Load Rating N	
			L1	L2	L3	Travel deviation e_p	Variation V_{300}				Dynamic C_a	Static C_{oa}
SSRT1002-196R270C7	170	Ct7	196	200	270	± 0.03	—	0.080	~0.020	—	2200	4000
SSRT1002-396R470C7	370	Ct7	396	400	470	± 0.06	0.05	0.120				
SSRT1002-196R270C10	170	Ct10	196	200	270	± 0.13	—	0.160	~0.050			
SSRT1002-396R470C10	370	Ct10	396	400	470	± 0.27	0.21	0.240				

Note)Please refer to p-A287 for order code of end-journal machining.