

Flex Actuator

Motor-less type (Standard) Resin Lead Screw type Actuator

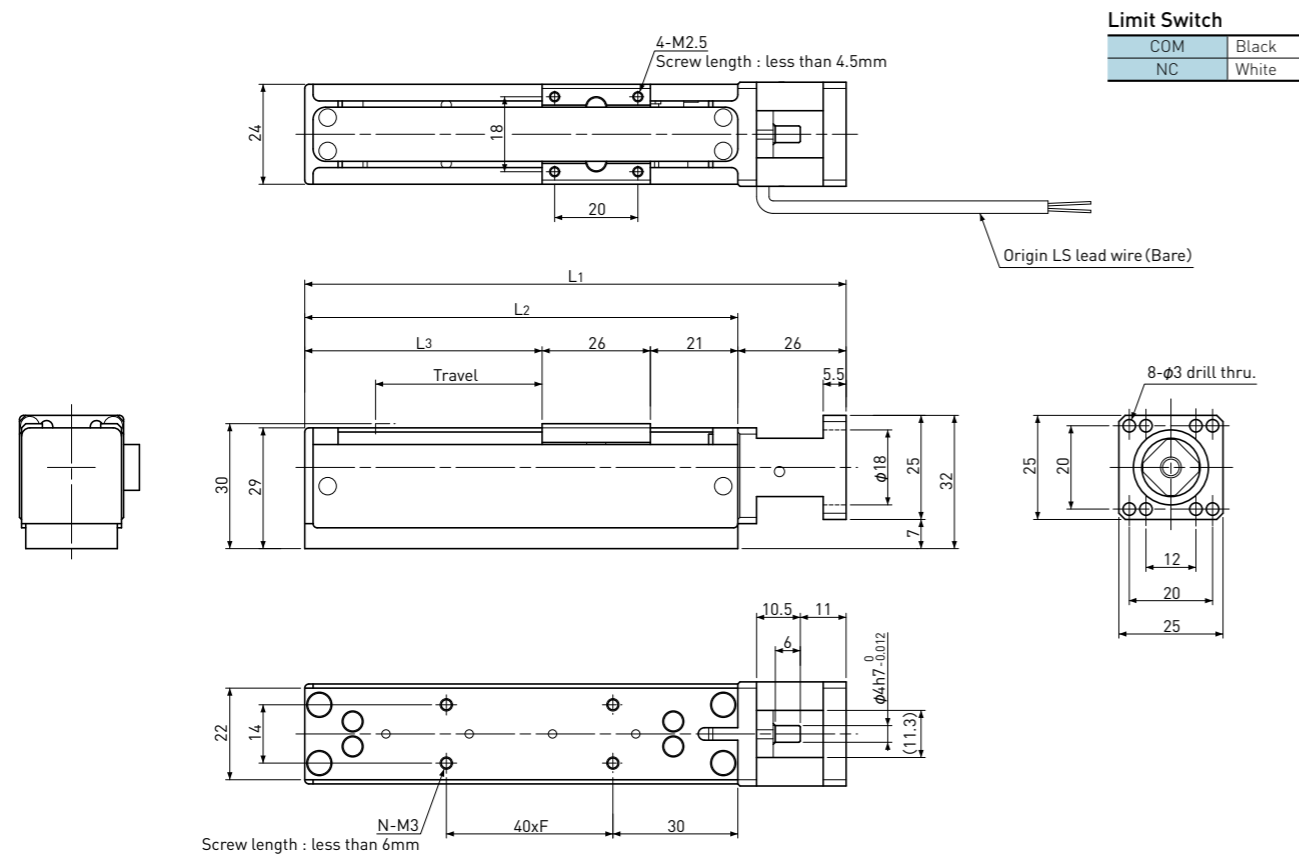

Note

- 1) There should be no condensation when using.
- 2) Permissible Moment is the number when no load in other direction.
- 3) Please consider Torque as reference number.
- 4) In case of Motor-less type, Repeatability & Lost motion are reference number.
- 5) In case of Motor-less type, Permissible speed & Load Capacity are recommended number.
- 6) Required Torque is under maximum vertical Load Capacity.
- 7) Recommended Coupling
 - SAKAI SEISAKUSYO : LAS-12C-4 × (3 or 4 or 5)
 - NBK : MWS-12C-4 × (4 or 5)
 - NBK : MOS-12C-4 × (3 or 4 or 5)
 - MISUMI : CPSCN12-4 × (4 or 5)

Model Number	Travel (mm)	Screw Lead (mm)	Motor Required Torque (Nm)	Length (mm)			M-thread hole		Max. Load Capacity (N)		Permissible speed (mm / sec)	Mass (g)
				L ₁	L ₂	L ₃	F	N	Hor.	Vert.		
FAS-Re020-040	40	2	0.008	130	104	57	1	4	9.8	4.9	0 ~ 30	155
FAS-Re060-040		6	0.010									
FAS-Re090-040		9	0.015									
FAS-Re020-080	80	2	0.008	170	144	97	2	6	9.8	4.9	0 ~ 30	200
FAS-Re060-080		6	0.010									
FAS-Re090-080		9	0.015									
FAS-Re060-120	120	6	0.010	210	184	137	3	8	9.8	4.9	0 ~ 90	240
FAS-Re090-120		9	0.015									
FAS-Re060-160	160	6	0.010	250	224	177	4	10	9.8	4.9	0 ~ 90	285
FAS-Re090-160		9	0.015									
FAS-Re060-200	200	6	0.010	290	264	217	5	12	9.8	4.9	0 ~ 90	325
FAS-Re090-200		9	0.015									

Note) In case of Resin Lead Screw type, Lubrication is Sumitec Liquid H20 on Resin Lead Screw, Grease MSG No.2 on Guide.

Common Specifications	
Repeatability	Max. ±0.05mm
Lost Motion	Max. 0.05mm
Body Material	Aluminum
Sliding guide	Slide Guide rail
Sensor	Limit switch
Accuracy of Zero pt. return	Max. ±0.05mm
Acceleration & Deceleration Rate	—
Permissible Moment	
Pitching Mp	0.10Nm
Yawing My	0.09Nm
Rolling Mr	0.23Nm
Lubrication	See Note
Operating Temp.	0 ~ 40°C